

# MALE STUD ELBOW

Thread BSP Taper

Type: **1020...1** Body

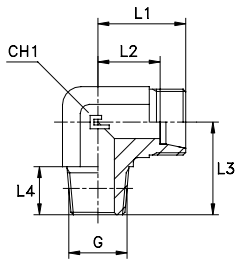

Type: **1020.. B3** Ring

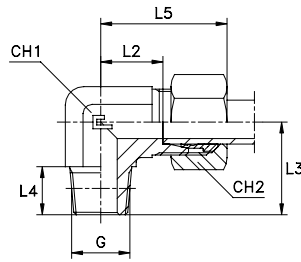

Type: **1020...4** B4 Ring

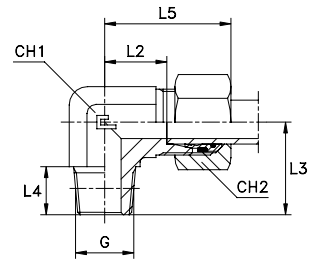

Series DIN	10.... [bar]	11.... [bar]	Ordering Body	Ordering Equipped B3	Ø Tube	G	L1	L2	L3	L4	L5	CH1	CH2	Ordering Equipped B4
LL	100	100	102001.1	102001	4	1/8	15	11	17	8	21	9	10	-
			102002.1	102002	6	1/8	15	9,5	17	8	21	9	12	-
			102003.1	102003	8	1/8	17	11,5	20	8	23	12	14	-
L	315	315	102004.1	102004	6	1/8	19	12	20	8	27	12	14	102004.4
			102005.1	102005	8	1/4	21	14	26	12	29	12	17	102005.4
			102006.1	102006	10	1/4	22	15	27	12	30	14	19	102006.4
			102007.1	102007	12	3/8	24	17	28	12	32	17	22	102007.4
			102008.1	102008	15	1/2	28	21	34	14	36	19	27	102008.4
			102009.1	102009	18	1/2	31	23,5	36	14	40	24	32	102009.4
	160	160	102010.1	102010	22	3/4	35	27,5	42	16	44	27	36	102010.4
			102011.1	102011	28	1	38	30,5	48	18	47	36	41	102011.4
			102012.1	102012	35	1 1/4	45	34,5	54	20	56	41	50	102012.4
			102013.1	102013	42	1 1/2	51	40	61	22	63	50	60	102013.4
S	630	630	102014.1	102014	6	1/4	23	16	26	12	31	12	17	102014.4
			102015.1	102015	8	1/4	24	17	27	12	32	14	19	102015.4
			102016.1	102016	10	3/8	25	17,5	28	12	34	17	22	102016.4
			102017.1	102017	12	3/8	29	21,5	28	12	38	17	24	102017.4
			102018.1	102018	14	1/2	30	22	32	14	40	19	27	102018.4
	400	400	102019.1	102019	16	1/2	33	24,5	32	14	43	24	30	102019.4
			102020.1	102020	20	3/4	37	26,5	42	16	48	27	36	102020.4
			102021.1	102021	25	1	42	30	48	18	54	36	46	102021.4
			102022.1	102022	30	1 1/4	49	35,5	54	20	62	41	50	102022.4
			102023.1	102023	38	1 1/2	57	41	61	22	72	50	60	102023.4
L	315	315	102024.1	102024	6	1/4	21	14	26	12	29	12	14	102024.4
			102025.1	102025	8	1/8	21	14	22	8	29	12	17	102025.4
			102026.1	102026	8	3/8	23	16	28	12	31	17	17	102026.4
			102027.1	102027	8	1/2	26	19	34	14	34	19	17	102027.4
			102028.1	102028	10	1/8	22	15	22	8	30	14	19	102028.4
			102029.1	102029	10	3/8	24	17	28	12	32	17	19	102029.4
			102030.1	102030	10	1/2	27	20	34	14	35	19	19	102030.4
			102031.1	102031	12	1/4	24	17	28	12	32	17	22	102031.4
			102032.1	102032	12	1/2	27	20	34	14	34	19	22	102032.4
			102033.1	102033	15	3/8	28	21	30	12	36	19	27	102033.4
102034.1	102034	18	3/4	34	26,5	42	16	43	27	32	102034.4			
S	630	630	102035.1	102035	12	1/2	28	20,5	32	14	37	19	24	102035.4
			102036.1	102036	14	3/8	30	22	30	12	40	19	27	102036.4
	400	400	102037.1	102037	16	3/8	33	24,5	37	12	43	24	30	102037.4
			102038.1	102038	20	1/2	37	26,5	36	14	48	27	36	102038.4
			102039.1	102039	25	3/4	42	30	42	16	54	36	46	102039.4
			102040.1	102040	30	1	49	35,5	48	18	62	41	50	102040.4

**Note:** If you wish to order AISI 316 stainless steel fittings, please change the first two digits from **10....** to **11....** .  
 If you wish to order AISI 316 stainless steel fittings with AISI 304 stainless steel nuts, please change the first two digits from **10....** to **14....** .  
 Items not included in the ISO 8434-1 Norm.